



CAI • DM • 2023

**CAI**

**International Driving Competition  
Internationales Fahrturnier  
28.04.-01.05.2023**

**Deutsche Meisterschaften**



**der  
Vierspanner Pferde**

**Geländeunterlagen/Plans  
CAI2\*-H2/CAI2\*-P4/CAI2\*-P2**



**CAI 2\***

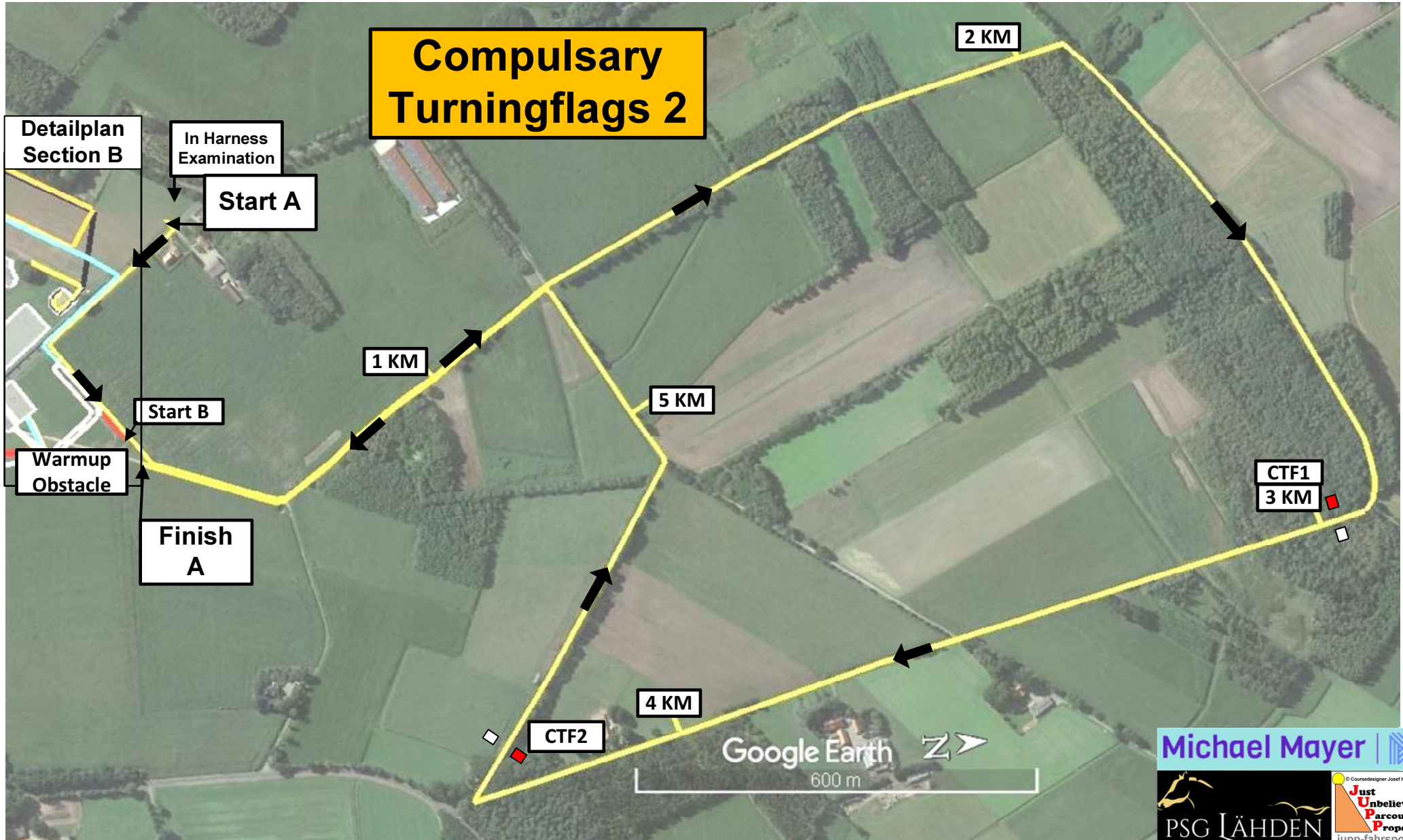

**Section B 2\***  
**5760 Meter**

**CTF**  
**1 - 20**



Downloadlink  
2\* Marathon

**Blue KM signs for 2\***

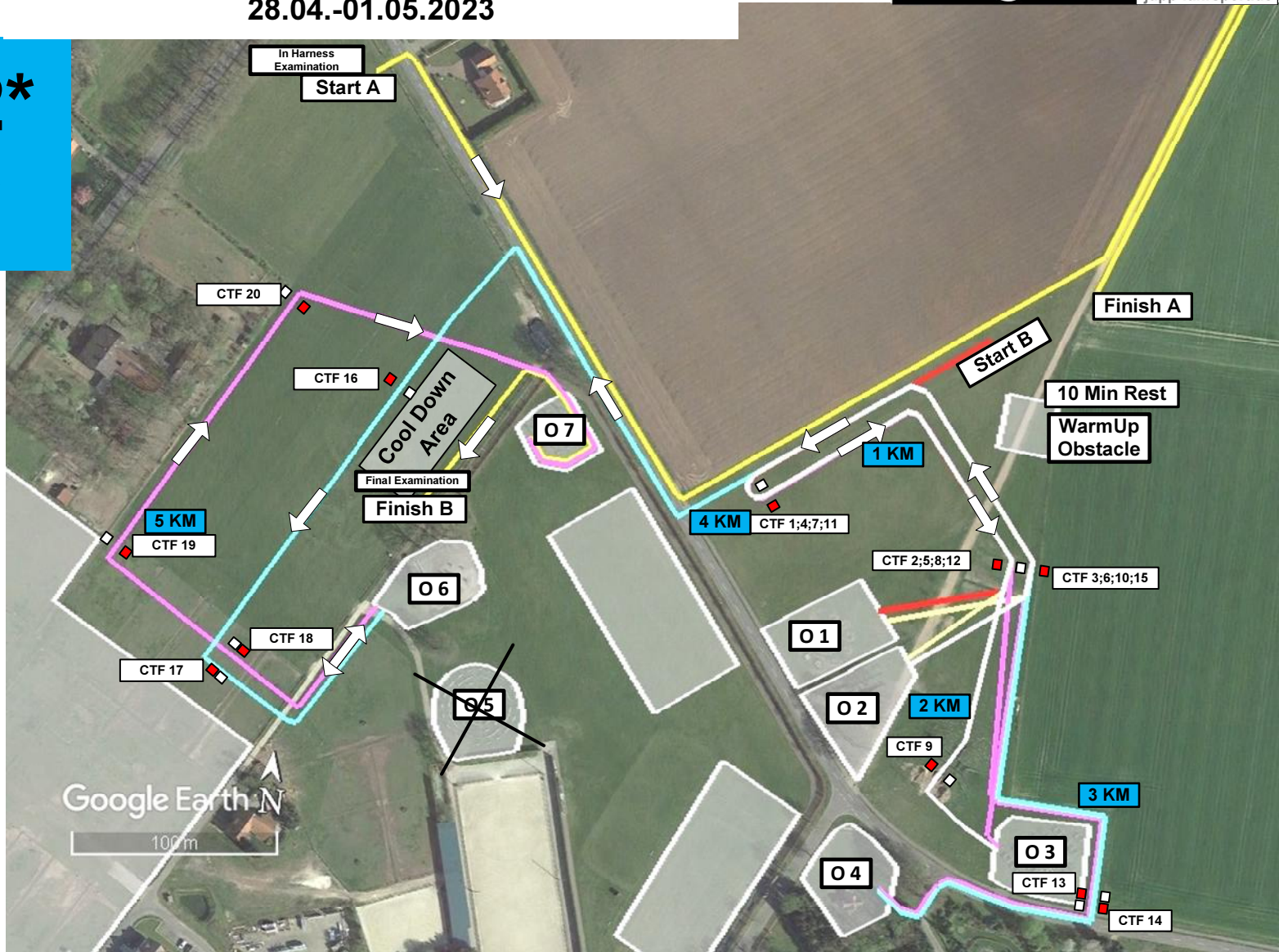

Legende: Start B / CTF1 / CTF2 / **O1** / CTF3 / CTF4 / **1KM** / CTF5 / **O2** / CTF6 / CTF7 / CTF 8 / **2KM** / CTF9 / **O3** / CTF10 / CTF11 / CTF12 / **3KM** / CTF13 / **O4** / CTF14 CTF15 / **4KM** / CTF16 / CTF17 / **O6** / CTF18 / CTF19 / **5KM** / CTF20 / **O7** / Finish B.

## Times Marathon / Geländezeiten

CAI 3* HORSES	Length in Meter	Tempo KM/h	Minimum Time h:min:sec	Time allowed h:min:sec	Maximum Time h:min:sec	Compulsory Turning Flags
Section A	5950	13	00:25:28	00:27:28	00:32:57	CTF 1-2
REST				00:10:00		
Section B	6890	14	00:26:32	00:29:32	00:59:04	CTF 1-25
Cool Down	Area		00:10:00		00:15:00	
CAI 3* PONYS	Length in Meter	Tempo KM/h	Minimum Time h:min:sec	Time allowed h:min:sec	Maximum Time h:min:sec	Compulsory Turning Flags
Section A	5950	12	00:27:45	00:29:45	00:35:42	CTF 1-2
REST				00:10:00		
Section B	6890	13	00:28:48	00:31:48	01:03:36	CTF 1-25
Cool Down	Area		00:10:00		00:15:00	
CAI 2* HORSES	Length in Meter	Tempo KM/h	Minimum Time h:min:sec	Time allowed h:min:sec	Maximum Time h:min:sec	Compulsory Turning Flags
Section A	5950	13	00:25:28	00:27:28	00:32:57	CTF 1-2
REST				00:10:00		
Section B	5760	14	00:21:42	00:24:42	00:49:24	CTF 1-20
Cool Down	Area		00:10:00		00:15:00	
CAI 2* PONYS	Length in Meter	Tempo KM/h	Minimum Time h:min:sec	Time allowed h:min:sec	Maximum Time h:min:sec	Compulsory Turning Flags
Section A	5950	12	00:27:45	00:29:45	00:35:42	CTF 1-2
REST				00:10:00		
Section B	5760	13	00:23:36	00:26:36	00:53:12	CTF 1-20
Cool Down	Area		00:10:00		00:15:00	

Powered by:



**„Bockmeyer-  
Brunnen“**

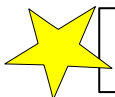
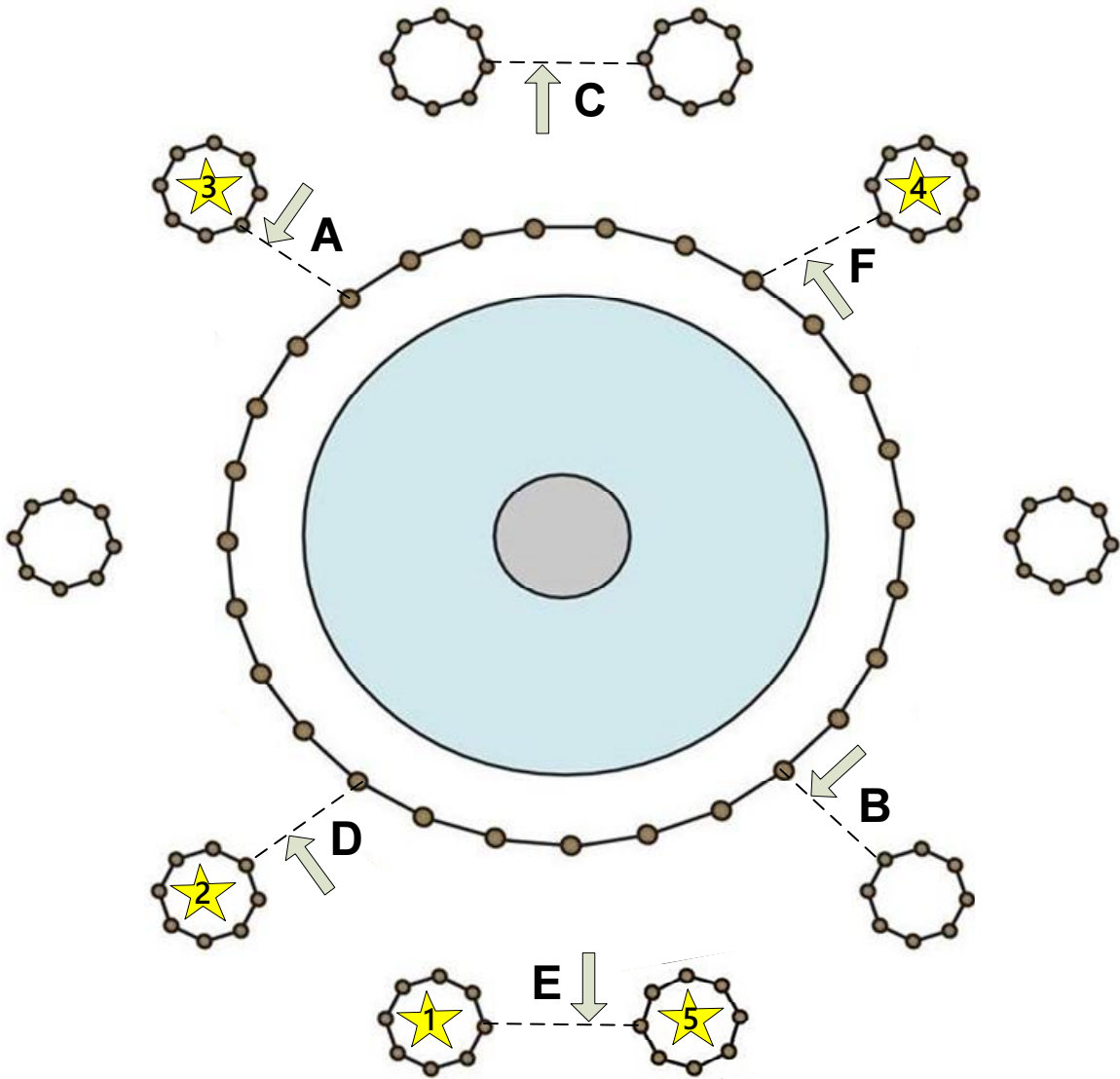

= 5 abwerfbare Teile/  
Knock Down

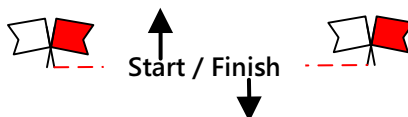

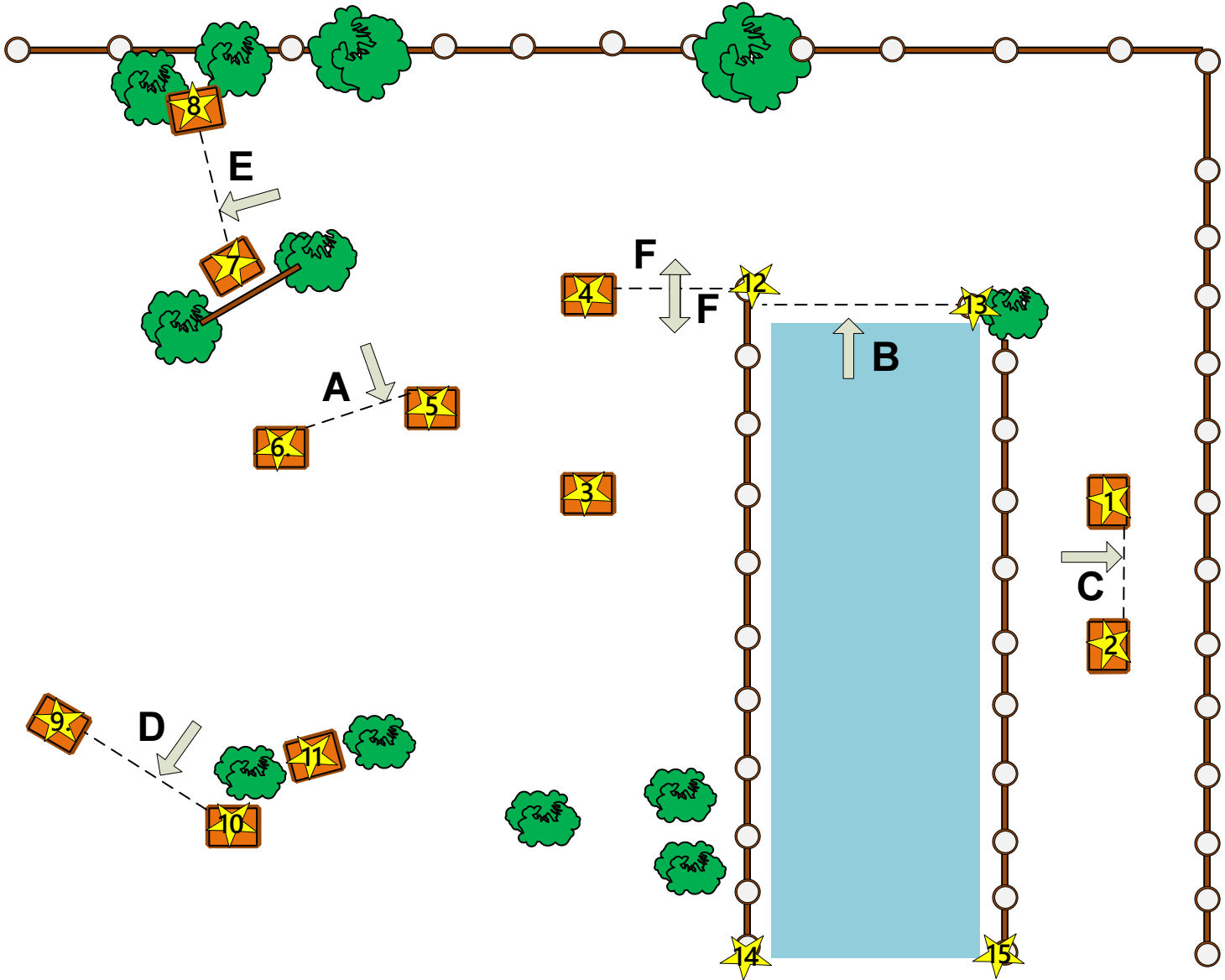

 = 15 abwerfbare Teile/  
Knock Down

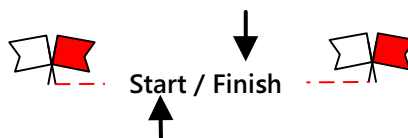

Powered by:

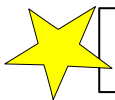
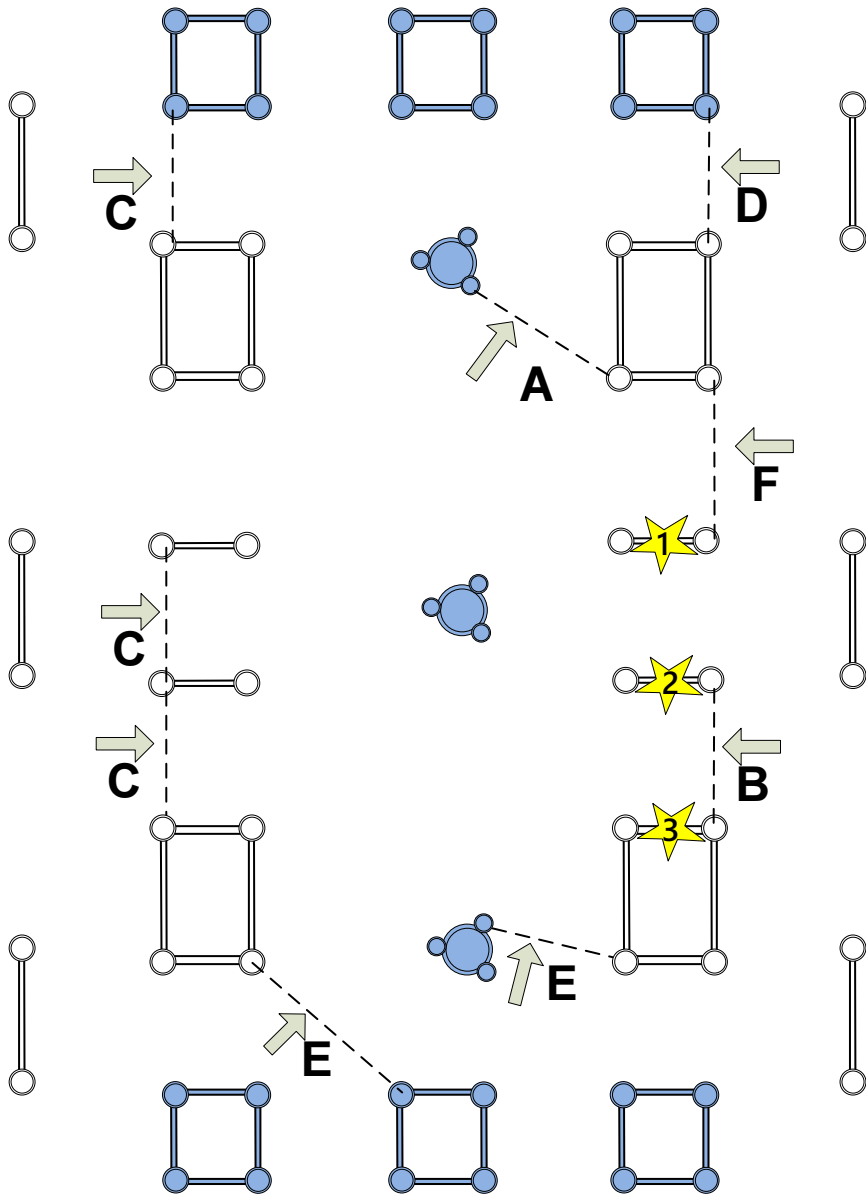

= 3 abwerfbare Teile/  
Knock Down



Start / Finish



Powered by:



„SCHULTE -  
Heuerhaus“

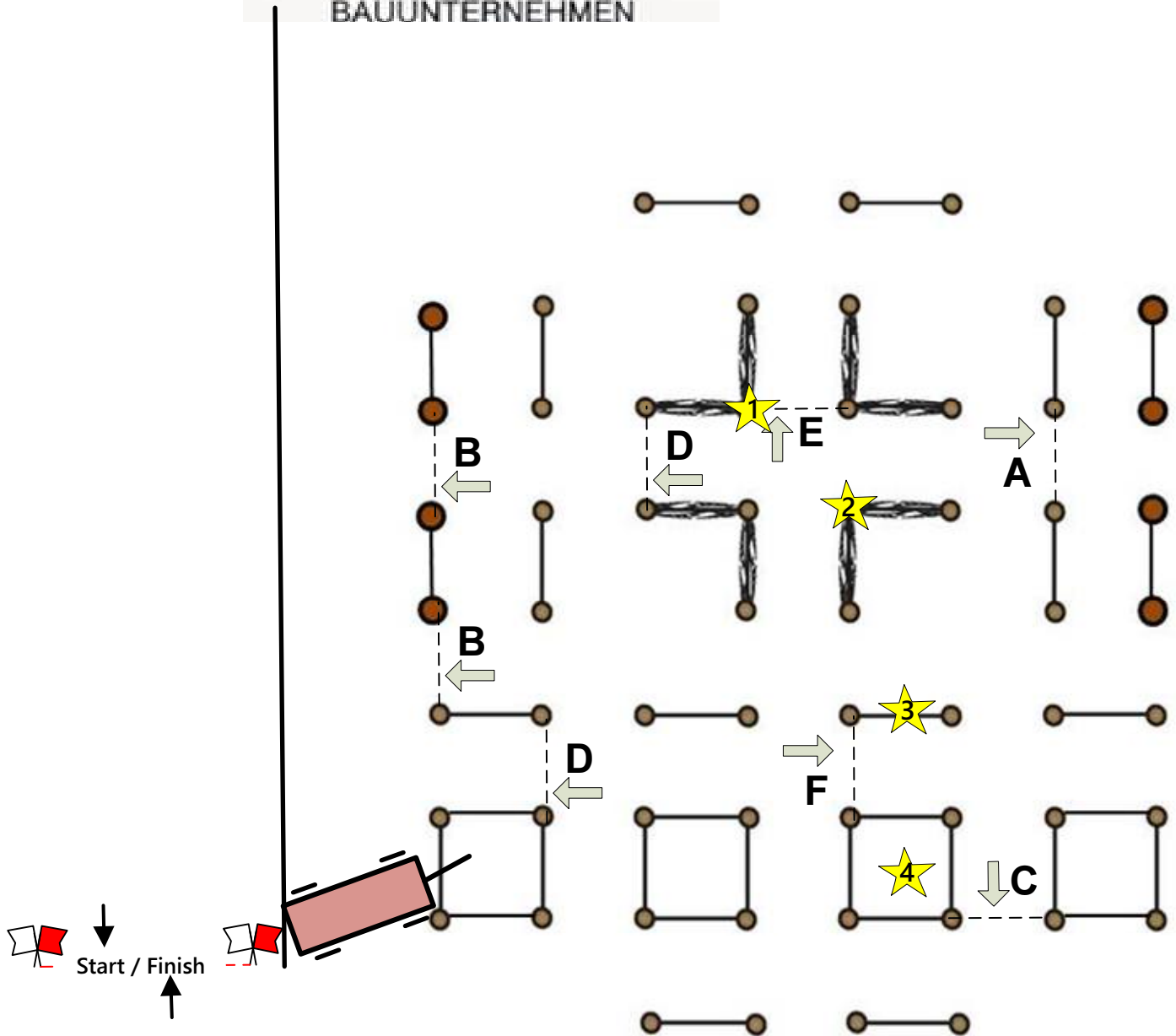

= 4 abwerfbare Teile/  
Knock Down





CAI · DM · 2023

Hindernis

Obstacle

6

„Eichenwall“

Powered by:

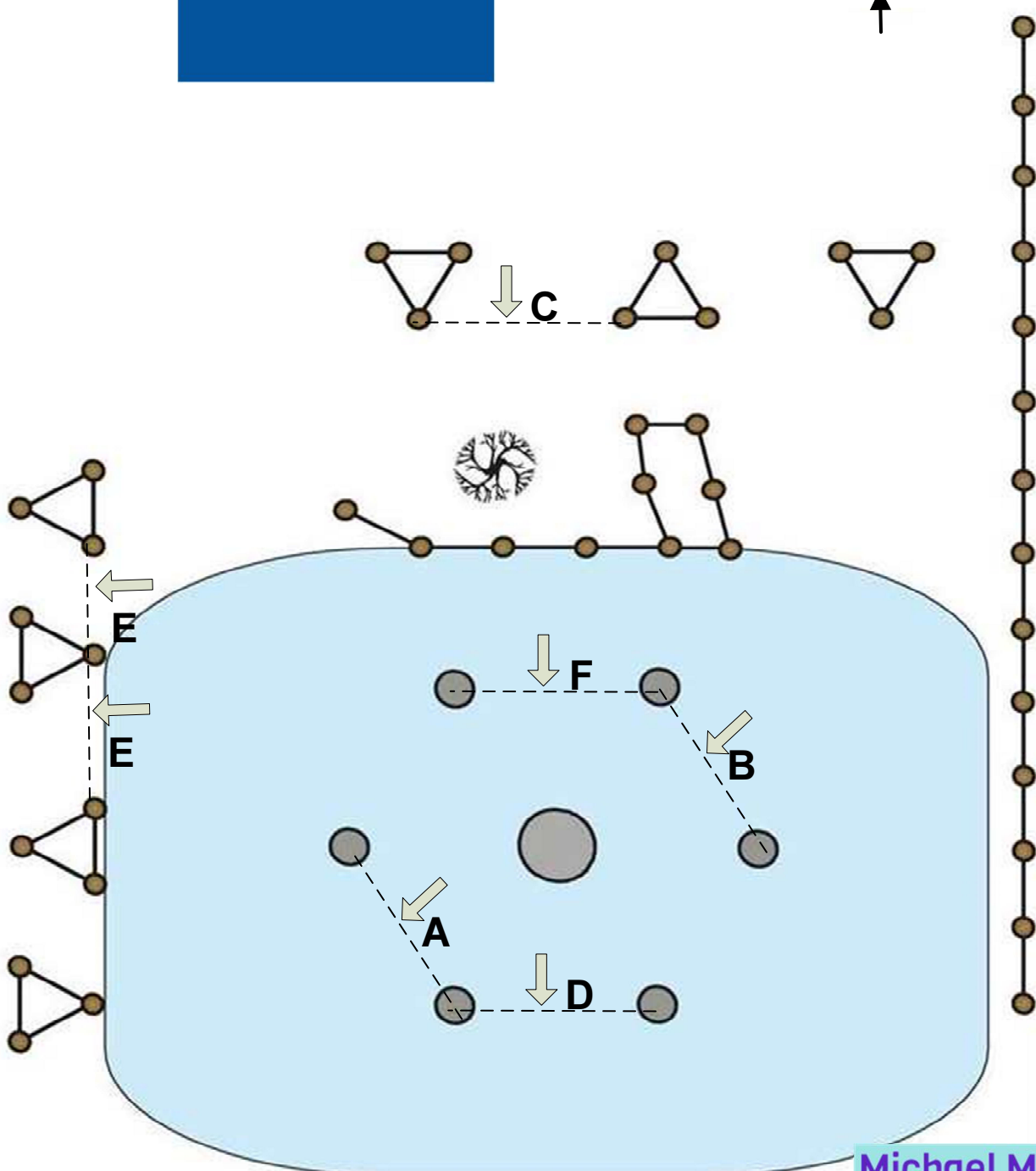
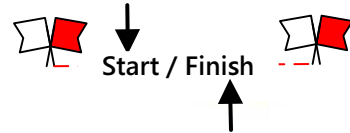

Michael Mayer | [Logo]



Powered by:

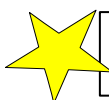
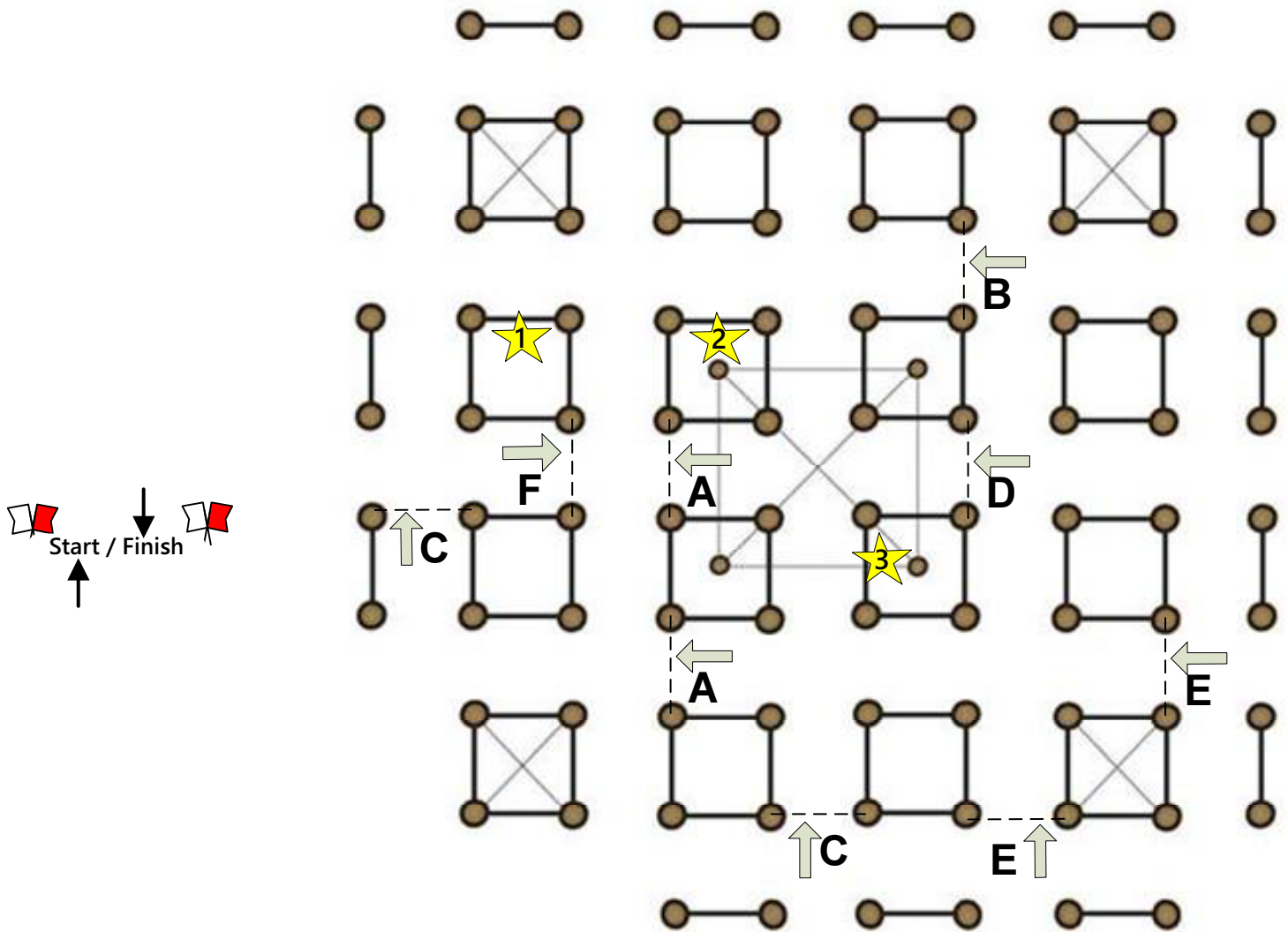

= 3 abwerfbare Teile/  
Knock Down